

Vacant

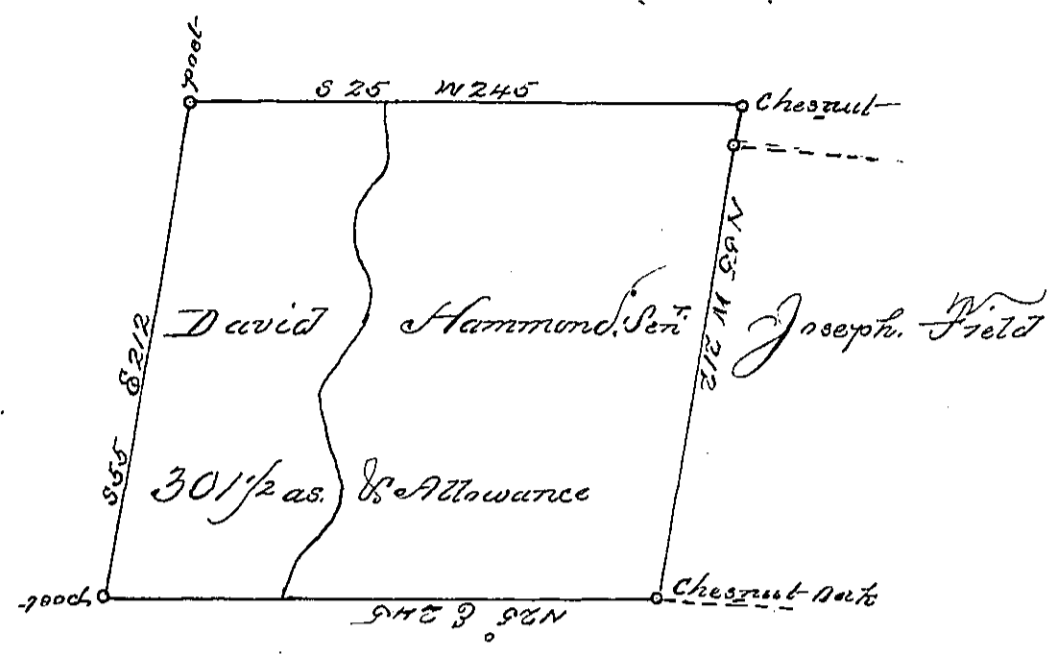

A Draught of a Tract of Land called the Diamond situate on the Allegany Mountain about a mile North from that Part of the Road leading from Frankstown to Kittanning where the same passes the Spring on the Hill after rising the same from Juniata adjoining Land of Joseph Field in the County of Bedford. Containing three hundred ^{and a half} ~~one~~ Acres & the usual ^{allowance} of six ^{per} cent. for Roads ^{as} surveyed the 15th day of ^{Jan} 1746 for David Hammond ^{sen} in pursuance of a warrant Dated the 25th Day of October 1743 by

Thomas Smith D.J.

To John Lukens Esq^r
Surveyor General

IN TESTIMONY that the above is a copy of the original remaining on file in the Department of Internal Affairs of Pennsylvania, made conformably to an Act of Assembly approved the 16th day of February, 1833, I have hereunto set my Hand and caused the Seal of said Department to be affixed at Harrisburg, this

_____ ^{North} day of ^{April} 1891

Wm. J. Stewart
Secretary of Internal Affairs